

Poziom porównawczy 120,00 m n.p.m.

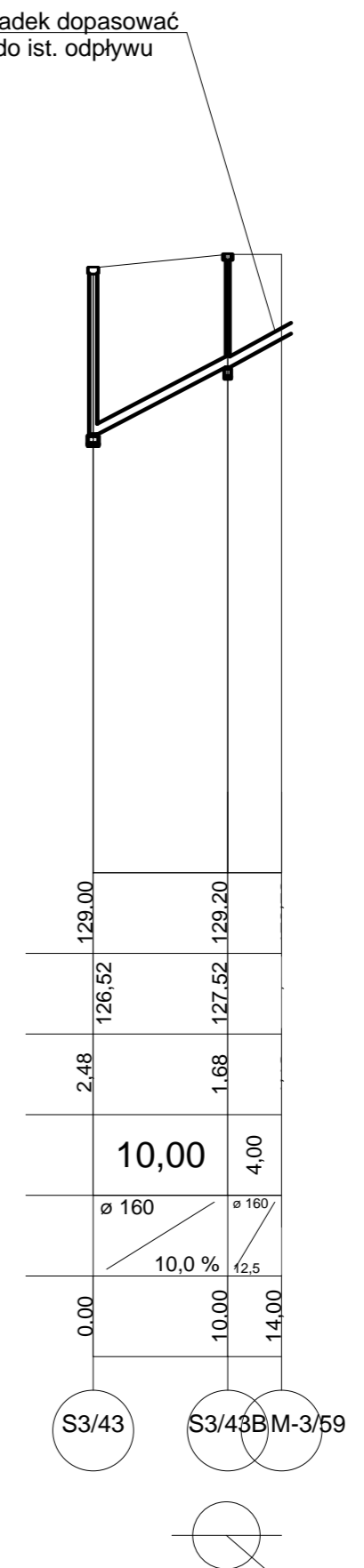
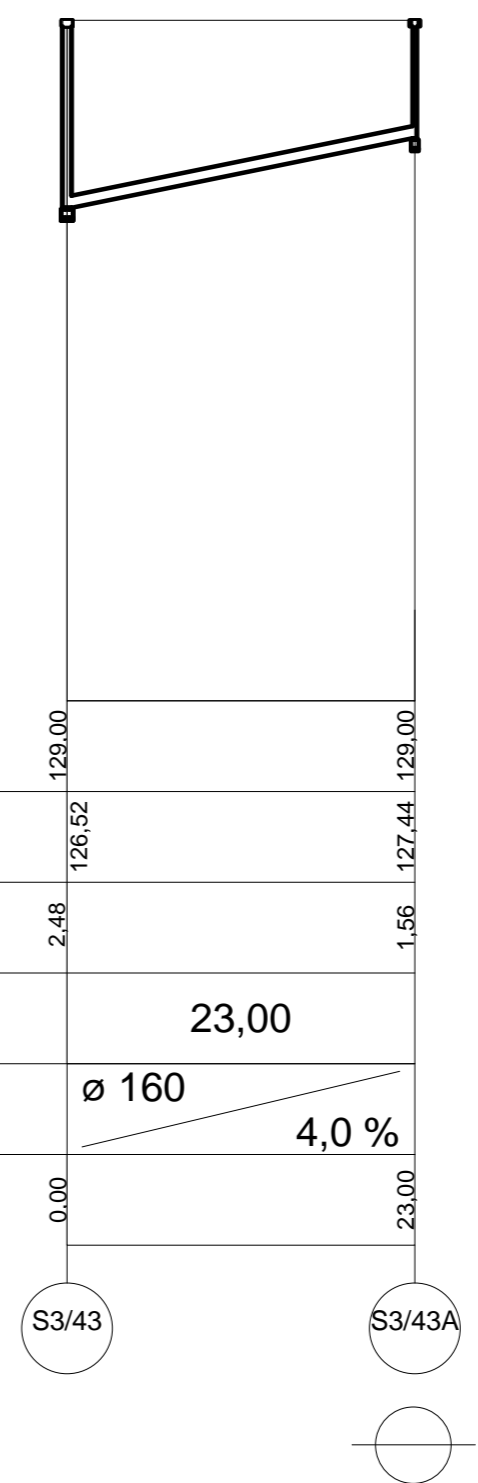
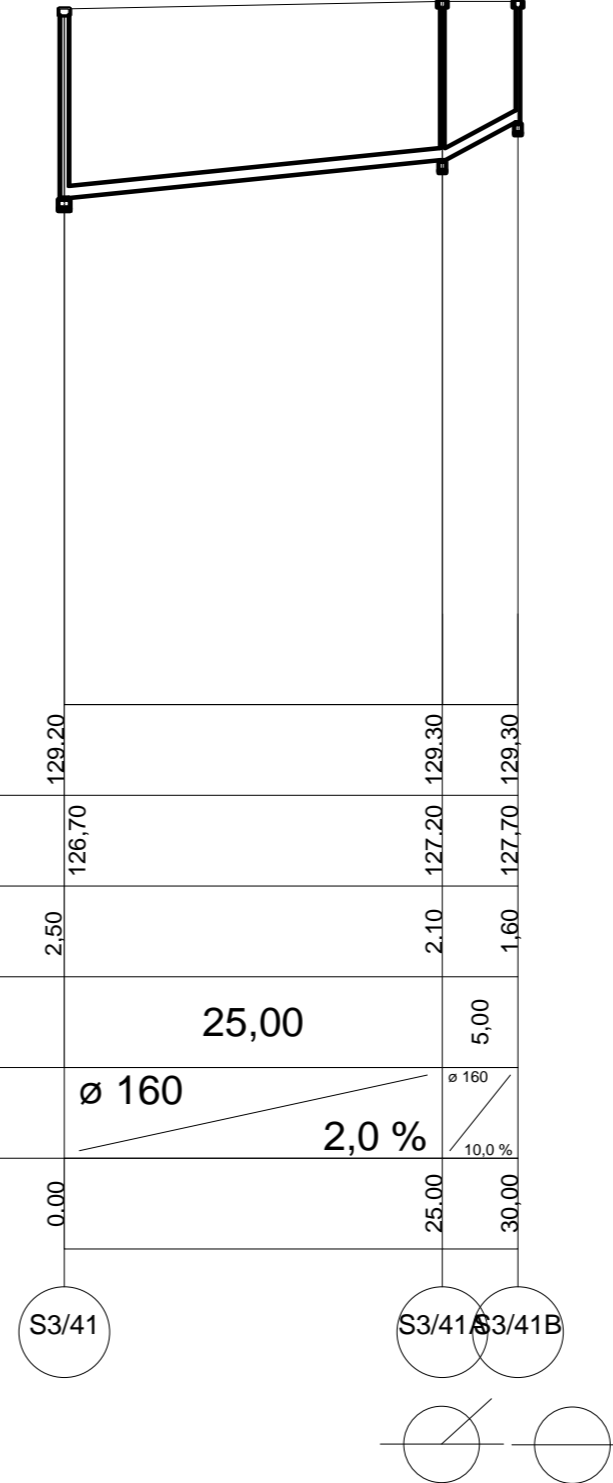
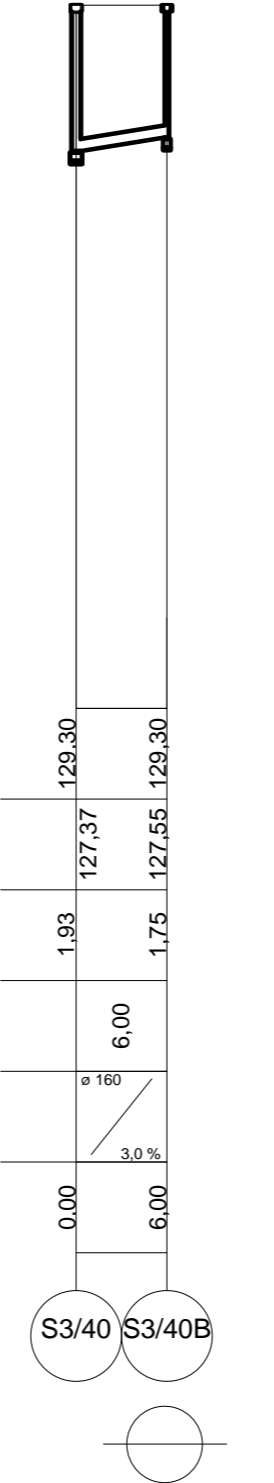
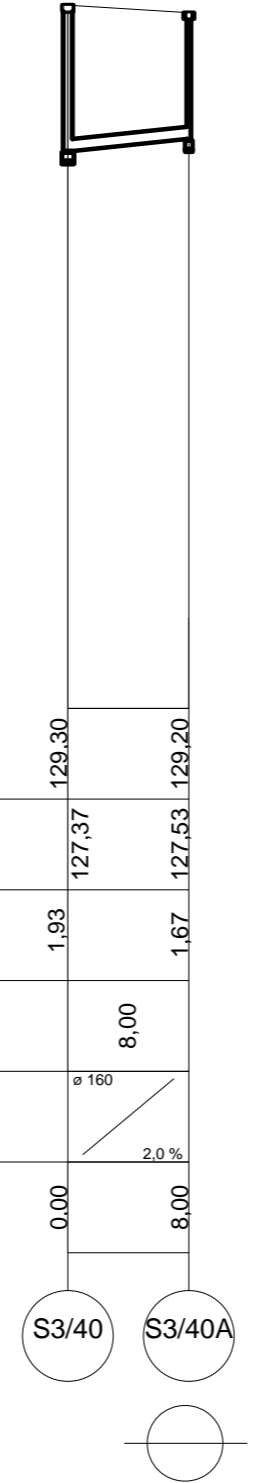
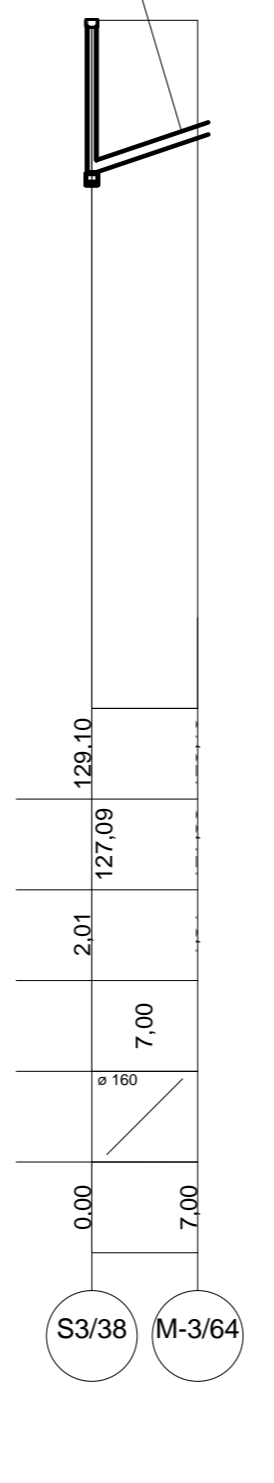
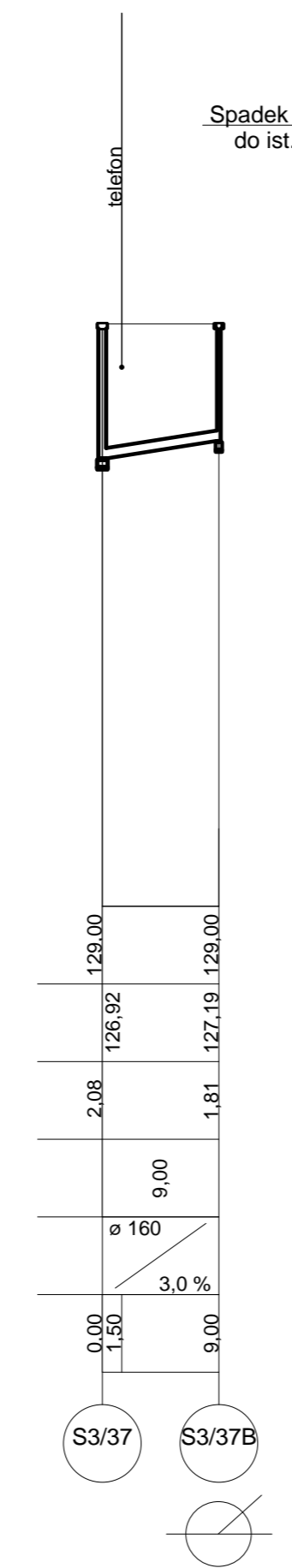
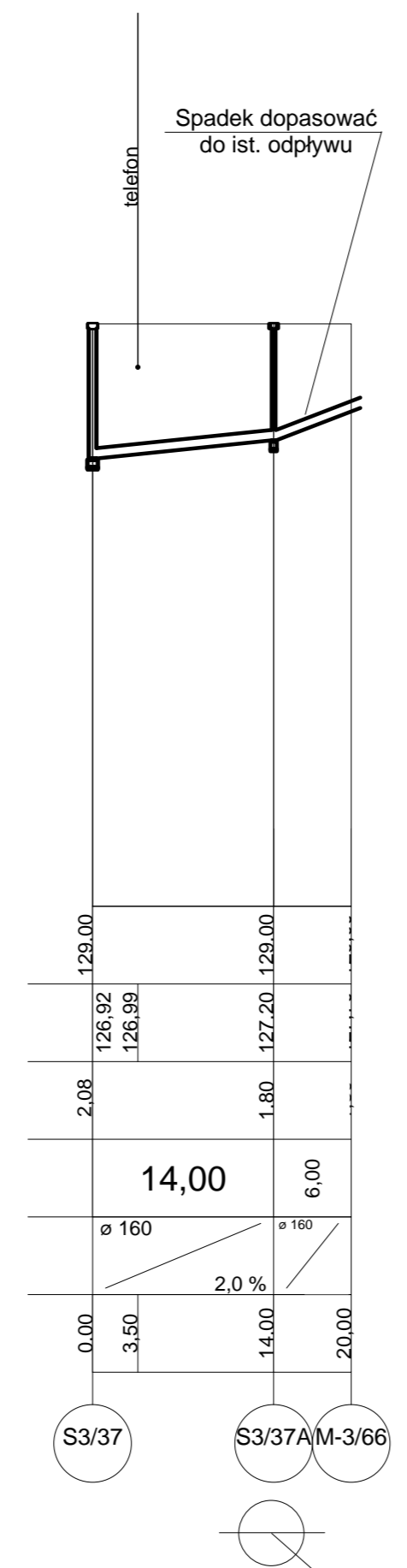
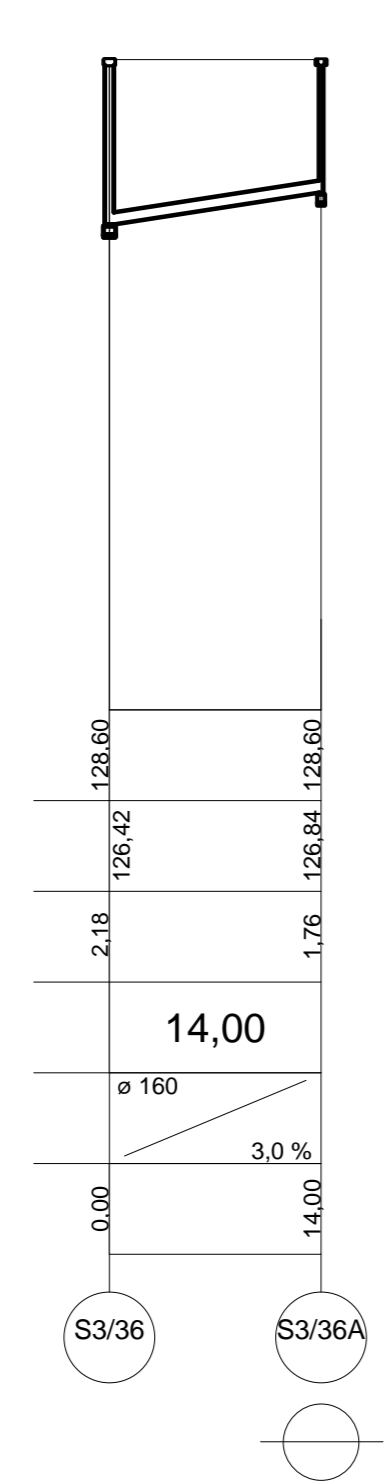
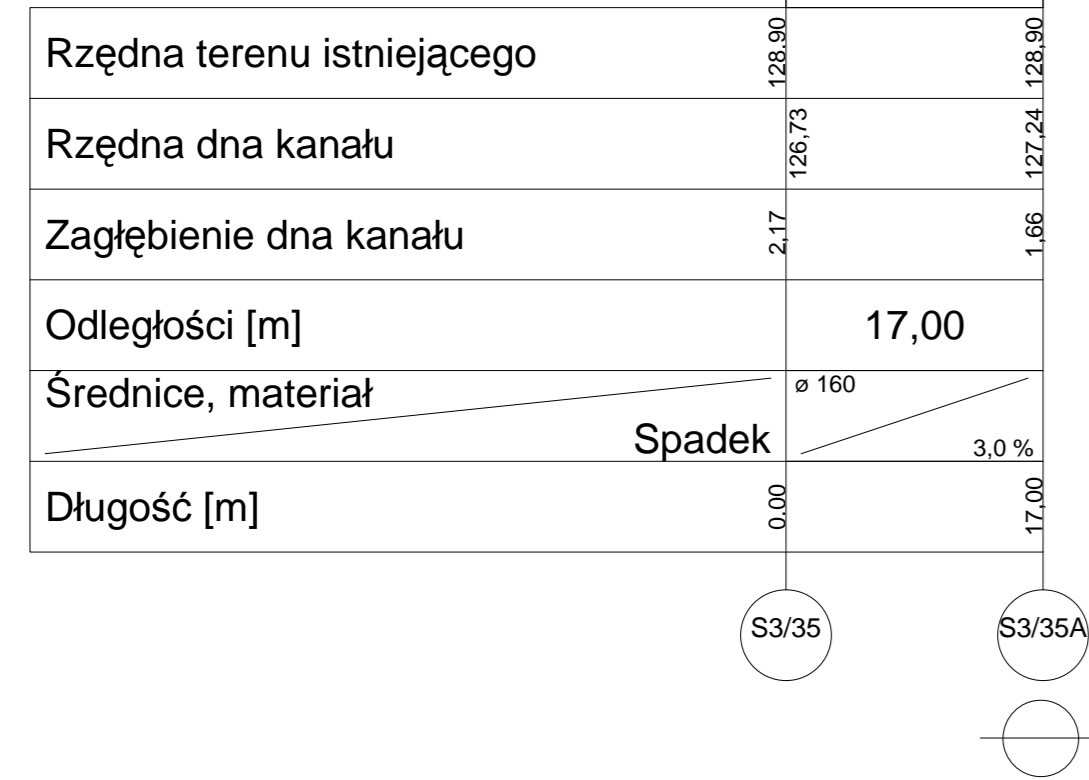

<b>PUH "ANDEX"</b> Ciechanów	<b>SKALA</b> 1:500/100	<b>DATA OPRAC.</b> 11.01.2010 R	<b>NR RYS.</b> 22.7
<b>TEMAT:</b> Kanalizacja sanitarna grawitacyjno-tłoczna PONIATOWO etap I i II - Gmina Żuromin			
<b>FUNKCJA</b>	<b>NAZWISKO I IMIĘ</b>	<b>NR UPR.</b>	<b>PODPIS</b>
Projektant	MGR INŻ. MAREK PIETRZAK spec: sieci i instal. sanit.	CIE-4/81	
Asyst. Projektanta	INŻ. BOLESŁAW JASIŃSKI spec: instal. sanit.	202/77/OL	